



first
environment
limited

Arboriculture

BS 5837: 2012 'Trees in Relation to Design, Demolition and Construction':

This document is produced to show that the guidelines relating to trees and development have been correctly applied and sets out important information in an accessible manner.

To comply with this standard a tree survey is conducted to gather information including tree dimensions and a quality assessment. This information is presented in a tabular format as a Tree Schedule (TS) and graphically as a Tree Location Plan (TL).

A Tree Constraints Plan (TCP) is then produced. This is a design tool for the team to help inform the layout and highlights the main tree-related constraints. As such it is not part of the final submission but is a key drawing when considering development on a site.

Once a draft layout has been produced an Arboricultural Impact Assessment (AIA) is created to check the feasibility of the plans and ensure that impacts on retained trees are within acceptable limits. Revisions are suggested as required and are part of an ongoing and iterative design process.

Once a layout has been agreed, a Tree Protection Plan (TPP) is created. This document details the protection measures that will be used to ensure the trees' safety throughout the building process. The TPP will be included within an Arboricultural Report which will explain the process, clarify the decisions made and explain the methodology for any mitigation works required by the proposals.

We are happy to help with a project at any stage, but the earlier these primary constraints are identified and addressed the fewer changes are likely to be required in the long run.

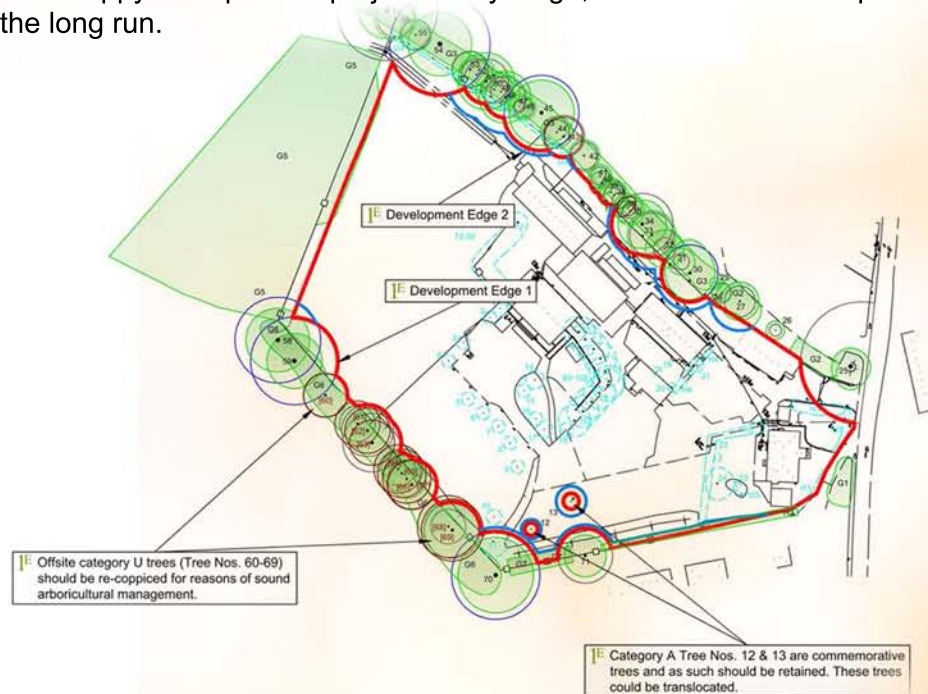

Duty of Care Report:

Tree No.	Species	Specification of Work:	Time Frame:
21	English Oak	Crown reduce, leaving a radial canopy of 7m, and a canopy height 16m. Sever ivy at base (budget permitting).	1 Year
G1	Cherry Laurel	Trim and shape.	1 Year
G2	Various	Remove the conifers from the northern side and adjacent vegetation to enable revised landscape treatment.	1 Year
G3	Leyland Cypress	No work required.	N/A

A Duty of Care / Tree Hazard Assessment is a vital tool that highlights any remedial works required in order to mitigate risk, especially in areas of high footfall or active highways. This document will demonstrate that reasonable measures have been taken by a landowner to minimise any risk posed by their tree stock.

This begins by completing a tree survey. One of our Arboricultural Team will attend the Site and carry out an inspection, recording information about the trees' locations, structural integrity, the surrounding environment and future management recommendations.

With this information a Tree Location Plan will be created, along with a Duty of Care Report. This states the level of risk posed by each tree and specifies short-term and long-term work that will need to be carried out to enhance their future contribution.

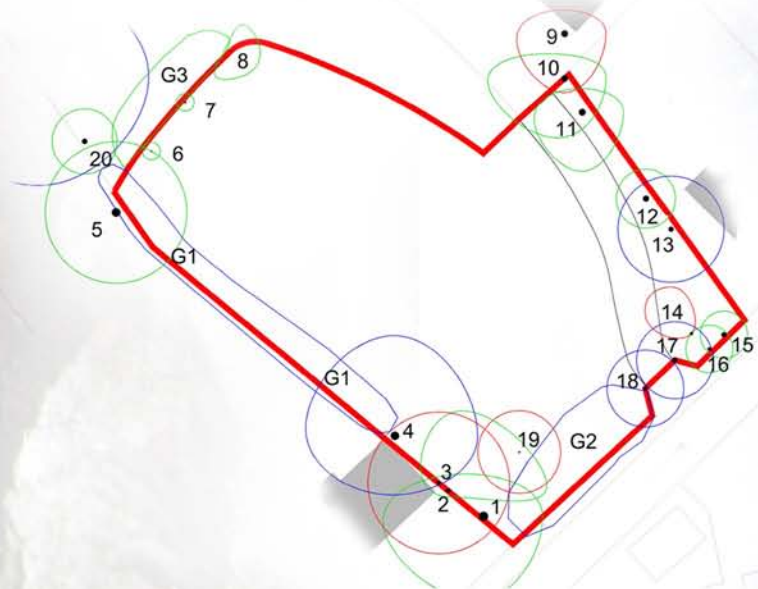

Woodland Management Plan:



This document is created with the aim of managing a woodland or forest to achieve a specific goal. These aims may cover a multitude of objectives from increasing biodiversity and conservation to increased timber production.

The Woodland Management Plan begins with a survey to identify the current state of the woodland, including the species and structure. The woodland may then be broken up into zones and each zone given individual aims and objectives tailored to its needs; outlining the management strategy in the long- and short-term as well as how this is going to be achieved.

Finally, a step by step document is created presenting the proposed management and when each stage of the process needs to be completed.

